

Please read the user manual carefully before use,
then it can be ready for checking in the future.

Air Scaler



Dental Fiber Optic Air Scaler

Sonic L

User Manual

/ foreword

Customer satisfaction is the primary task of our quality policy. This product design, manufacture and test is in accordance with the requirements and standards of the current regulations.

For the safety of your patients and before you use it for the first time, please read the instructions. These instructions will describe how to use your product and how to ensure it work smoothly and effectively.

1

Expected usage

The device is a dental treatment instrument which is using air as the power source. It can be handled by the manufacturer's permission to complete the following treatment: removal of gingival subgingival calculus, cleaning teeth, root surface formation, root canal preparation and inlay preparation and so on.

Limit the use of qualifications

Our development and design of this medical device is based on the needs of the medical device such as dentists, dentists, dental practitioners (preventive treatment) and dental assistants.

/ Limit wrench use precautions

Firstly, insert the tip into the wrench, and then hold **A**, screw the tip into the machine, until you hear "da" "da" "da" three times for the tightening, the air scaler can work properly.

Please don't hold B to tighten the tip, otherwise the wrench will lose the limit effect!

Excessive force will cause the dentist port, burst, damage the machine!

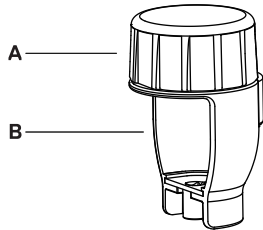

Limit wrench

/ symbol

Manufacturer logo



Do not treat it
as garbage



Manufacture date



Warning!
The risk of injury



Attention!
Avoid damage



General explanation
No risk to people or things

SN

Serial number



Autoclavable and
sterilizable at 135 °C



Clean and disinfect
with hot disinfectant

Safe instruction	5
Product description	8
Operation	10
hygiene and maintenance	13
Technical Parameters	20
Recycling and disposal	21
Warranty	22

/ Safety instruction



- > Ensure correct operating conditions and ensure adequate cooling.
- > Provide adequate coolant and ensure proper suction. The coolant supply turns off the device immediately when a fault occurs.
- > As a drive source for the equipment, use only air compressors to provide filtered, oil-free and cooled compressed air.
- > Check the parts of the equipment for damage or loosen (eg tip) before each use.
- > Do not use if the device is damaged.
- > Test it before each treatment.
- > Do not use the device in the case of soft tissue damage in the oral cavity (which may cause the infectious substance to penetrate into the tissue to initiate the embolization).
- > It is best to run the rinse function of the device once a day.
- > Do not use the device as a lighting fixture.



- > Keep your eyes out of the fiber.
- > Only use the original tip and wrench.
- > Make sure that the original shape of the tip has not changed (eg, thrown to the ground).
- > The tip can not be broken or drilled.
- > Each time you restart, check the power settings.
- > The tip can only be installed when the device is stopped.
- > Do not touch the tip of vibration
- > Immediately after the completion of each treatment with a wrench on the tip (to prevent damage and infection, to protect the work of the tip)
- > Check the work of the sharp wear. The tip of the work must not wear more than 2mm.

/ Safety instruction

Hygiene care and maintenance prior to first use



The delivered equipment is sealed in a clean PE bag.

- > High temperature and high pressure sterilization of equipment, tip and wrenches.
- > Immediately after each treatment, insert the wrench with a wrench (to prevent damage and infection, to protect the tip).
- > Check the work of the sharp wear. The tip of the work must not wear more than 2mm.

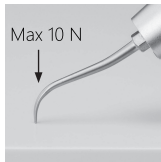

The tip may be damaged by continuous pressure or damage (if dropped to the ground or bent). Therefore, before each use, check the work of the tip to see if it is safe. Use your thumb or index finger to gently press the tip of the work to check.

- > An extra safety check, press it with 1 kg of force without running to see if it is broken.

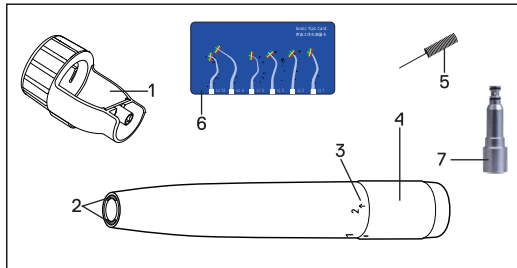

- 1-Limit wrench
- 2-The end face of fiber
- 3-Power level indication
- 4-Power adjustment ring
- 5-Nozzle cleaner
- 6-Air scaler tip measuring card
- 7-Refueling nozzle

/ product description

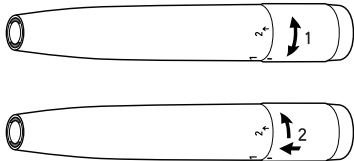

Power adjustment ring to set the power strength

Power indicator "1": softness

Power indicator "2": standard strength;

Power marked "3": enhanced cutting in a short time.



Power Level 3: Avoid any type of over-operation

1-Rotate the adjustment ring clockwise to set the power level 1 to 2;

> **A safety lock is provided at power level 2.**

2-Set the power level 3 method: push forward the adjustment ring, To avoid the security lock, while clockwise rotation adjustment ring.

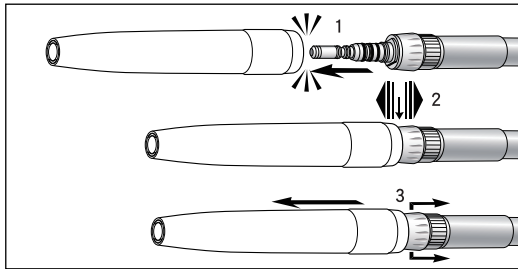

Connection and disassembly



Do not connect and disassemble during work!

1. Insert the quick connector into the device connector;
2. Check that the equipment is securely fastened to the quick connector;
3. Unplug the device from the quick connector.

/ Operation

Tip Installation

- > Carefully insert the tip carefully into the force wrench and clamp it;
- > Place the tip into the device port thread;
- > Tighten the tip until you hear "click""click";
- > remove the wrench carefully.



1. by pulling the tip to ensure that the tip is firmly loaded into the equipment;
2. Press the tip of the tip on the surface of the sterile object (eg, the force wrench) and use a force of about 1 kg to test the carrying capacity of the tip.

Remove the tip

- > Carefully wrench the wrench on the tip of the work and tighten it.



The removal of the tip needs to remain in the force wrench until the cleaning is required.

Test



Do not lift the device to the eye level.

- > Installation tip;
- > Start the device;
- > In the event of a failure (such as vibration, abnormal noise, overheating, coolant failure or leakage), immediately stop using the equipment, contact authorized service partner maintenance.

/ hygiene and maintenance



- > In accordance with national laws and regulations, standards and guidance to clean, disinfect and sterilization;
- > Equipment, tip and force wrench, can be high temperature autoclave;
- > Wear protective clothing when cleaning and disinfecting;
- > Remove the device from the quick connector;
- > Remove the tip from the device;
- > In order to prevent other liquids (such as: blood, saliva, etc.) in the sterile into the fuselage parts, after each use of equipment, must immediately on the equipment body, tip and wrench cleaning and disinfection;
- > Sterilization and lubrication of equipment, tip and wrenches before sterilization;
- > To sterilize the tools used for cleaning and disinfection.

Disinfect before use

- > If severe contamination, please use a soft cloth with a disinfectant to clean the surface;
- > Use no protein coagulation effect of disinfectant only;

Body and external manual cleaning

- > Rinse and wipe with softened water (<38 ° C);
- > Remove other liquid residues (with a suction cloth or dry with compressed gas);
- > Clean the inside with a small cleansing brush until you can get it;



- > Do not place the equipment in a sterile solution or place it in an ultrasonic cleaner for cleaning and disinfection.
- > You can place the tip and the force wrench in an ultrasonic cleaner for cleaning and disinfecting.

/ hygiene and maintenance

Clean the outlet

- > Use # 15 or # 20 root canals to remove dirt and deposits from the outlet; clean the tail interface;

Wash the connector at the end

- > Use the air gun to blow the channel at the end of the device;
- > If the outlet of the channel is blocked, contact the authorized service partner for service. Clean the fiber out port;

Wash the optical port of the glass fiber

- > Clean the fiber out port with a soft cloth dampened with cleaning solution;
- > Use a gun or water soft cloth to dry the fiber light port carefully;



Avoid scraping the end of the fiber with a hard object.



Every time after cleaning should be visual inspection. Do not damage the fiber out of the port or contact the authorized service partner.

Artificial disinfection

- > We recommend wiping disinfection;
- > Can be disinfected with chlorine disinfectant only;



After manual cleaning, disinfection and lubrication, you must put the equipment, tip and wrench into the sterilization bag into the high pressure steam sterilizer for high temperature and high pressure sterilization.

/ hygiene and maintenance

Daily lubrication care

- > Attach the supplied fuel nozzle to the nozzle outlet of the lubricating oil bottle;
- > Then insert the nozzle into the device interface;
- > Hold the front exit of the device with a clean soft cloth (to prevent the excess from being sprayed to other places). Finally, press the lubricating oil bottle of the fuel injection switch, lubrication equipment.

Recommended lubrication cycle

- > Must be after each internal cleaning;
- > Before each high temperature autoclave;
- > Use more than 30 minutes or at least once a day.

Lubrication care after the test operation

- > Equipment front exit down;
- > In 5-10 seconds, power level 3 is modulated from power level 1;
- > Test equipment for at least 30 seconds to remove excess oil;
- > If any dirt is spilled during the test run, repeat the entire cleaning and sterilization process;
- > Test run is completed, with a soft cloth to wipe the equipment body.

Sterilization and storage

We recommend sterilization according to EN13060, Class B regulations.

- > Pay attention to the technical parameters provided by the manufacturer;
- > Clean, disinfect and lubricate before sterilizing;

/ hygiene and maintenance

- > Equipment and its accessories must be sterilized in the sterilization bag;
- > Make sure you remove the equipment and its accessories in the sterilizer is dry;
- > Save the sterilized items, need to keep clean and dry;

19



ISO15606 provides that the product of the cycle of disinfection at least 250 times.

Approved disinfection procedures

- > Use Sterilizers according to EN13060 Steam Sterilization Class B (Pretreatment and Vacuum).
At 135 ° C, the sterilization retention time is at least 3 minutes.

Operating pressure	2.5 - 3 bar
Water pressure	0.5 - 0.7 bar
Coolant flow rate	30 - 60 ml/min
Minimal coolant flow	30 ml/min
Air consumption	20 - 40 l/min
Oscillation frequency	5500 - 6000 hz
Oscillation amplitude	Less than 200 microns

Temperature information

Operators side of the pneumatic scaling machine temperature: up to 55 °C

Patient side of the pneumatic scaling machine temperature: up to 50 °C

The temperature of the working part (needle grinding head): up to 41 °C

Physical characteristics

Storage and transport temperature: -20 ° C to +70 ° C

Storage and transport air humidity: 5% to 95% (relative humidity), not liquefied

Operating ambient temperature: +10 ° C to +35 ° C

Operating air humidity: 15% to 80% (relative humidity), not liquefied

/ Recycling and disposal

Recycling

The Company attaches great importance to environmental responsibility. The pneumatic cleaning machine and its packaging in the design as much as possible to achieve environmental protection.



Pneumatic scaling machine disposal

- > Dispose of used electrical equipment in accordance with the principles, standards and requirements of your country (region).
- > Make sure the spare parts are not contaminated during disposal.

Disposal of packaging materials

All packaging materials are selected according to environmental standards, can be recycled. Please send the old packing material to the relevant collection and reprocessing system.

So you have made a contribution to the recycling of raw materials, thus avoiding waste.

The manufacturer undertakes a warranty for one year.

Damage to parts is not covered by warranty due to non-compliance with the operating instructions.

If you try to unpack your product, your product warranty will be canceled.

Note: The manufacturer reserves the right to modify the equipment and the manual without prior notice.



7033029 REVA